

REV	DESCRIPTION	ECN #	CHG BY	DATE	APP'D
A	CONVERTED TO 3D	PER MJC	NAD	07/14/16	EZR
B	UPDATED DRAWING STANDARD	WEBD	TAS	09/30/19	NAD

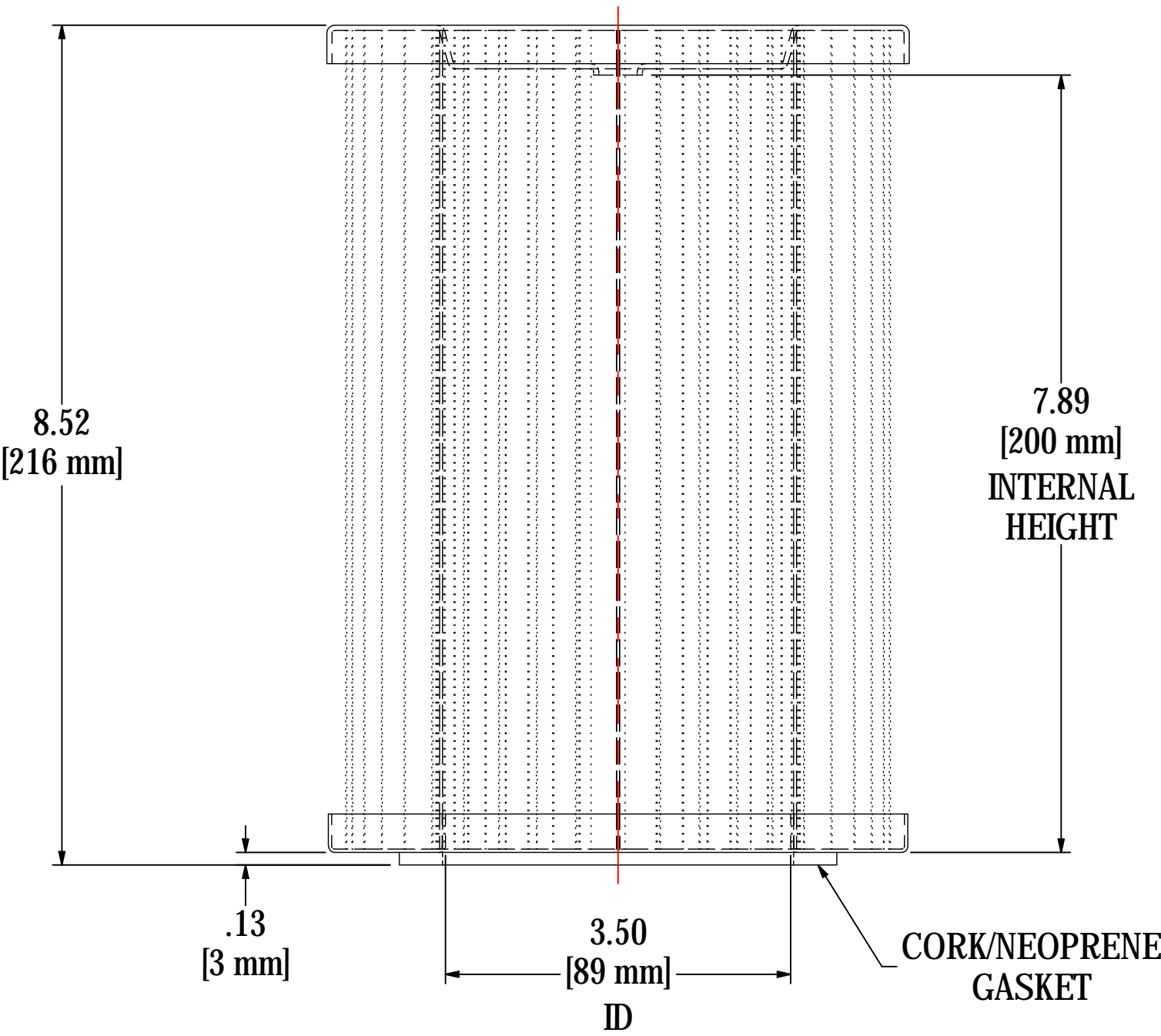
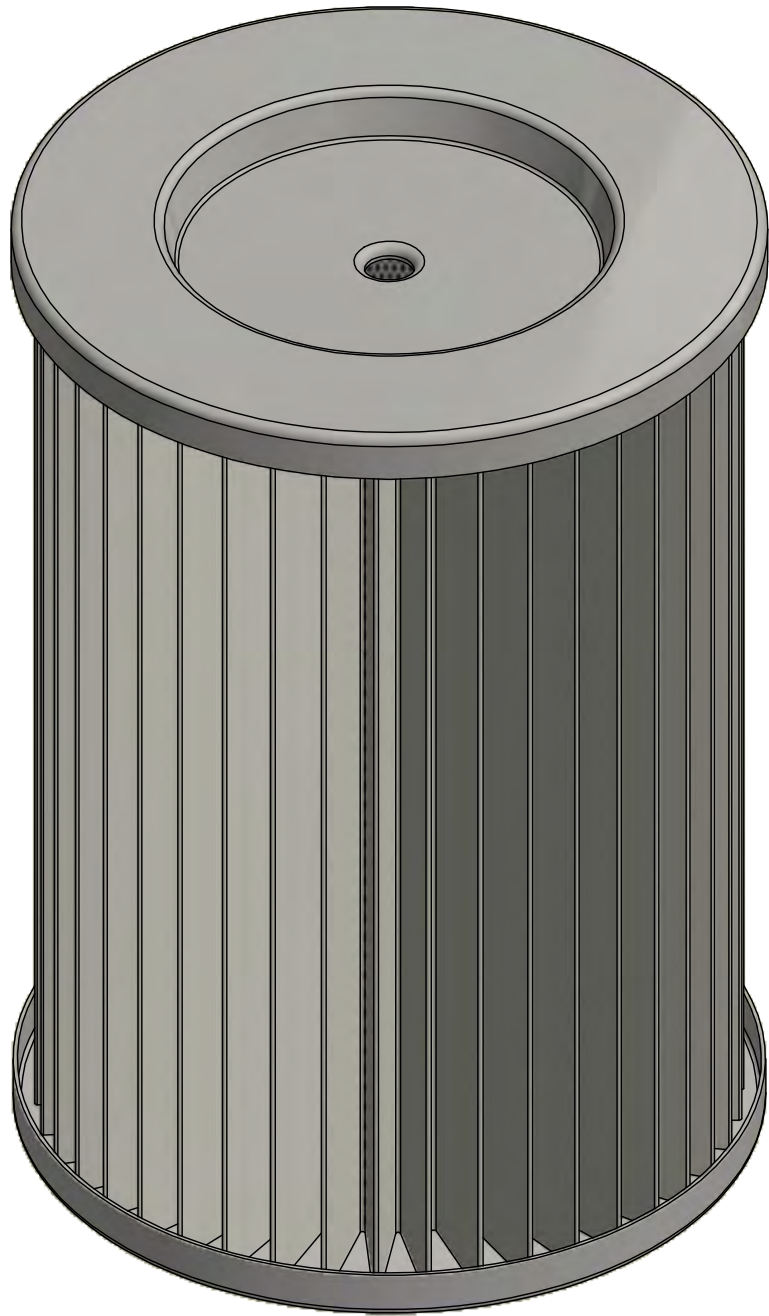
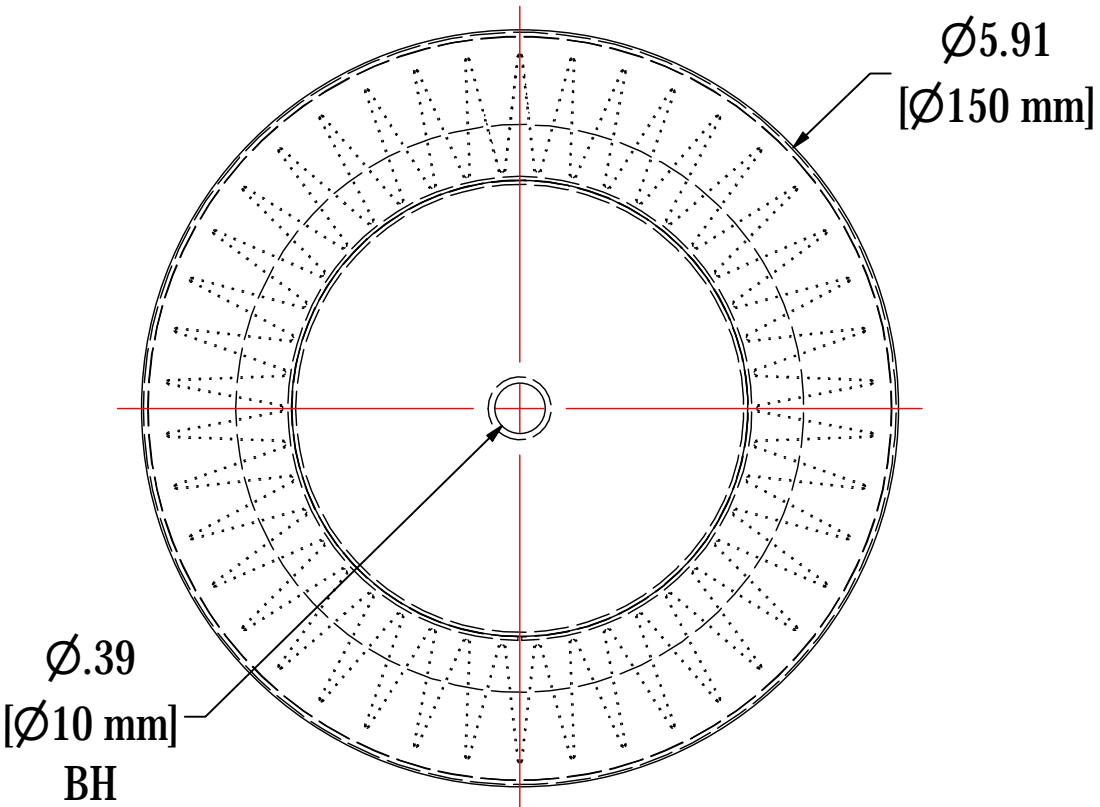

ELEMENT SPECS		
PART NUMBER	851/1	
MATERIAL	Polyester	
FLOW RATE	290 CFM	493 m³/hr
SURFACE AREA	4.8 ft²	0.4 m²
I.D.	3.50"	89mm
O.D.	5.91"	150mm
HEIGHT	8.52"	216mm