

REV	DESCRIPTION	ECN #	CHG BY	DATE	APP'D
A	CONVERTED TO 3D	WEB	TAS	10/23/19	NAD

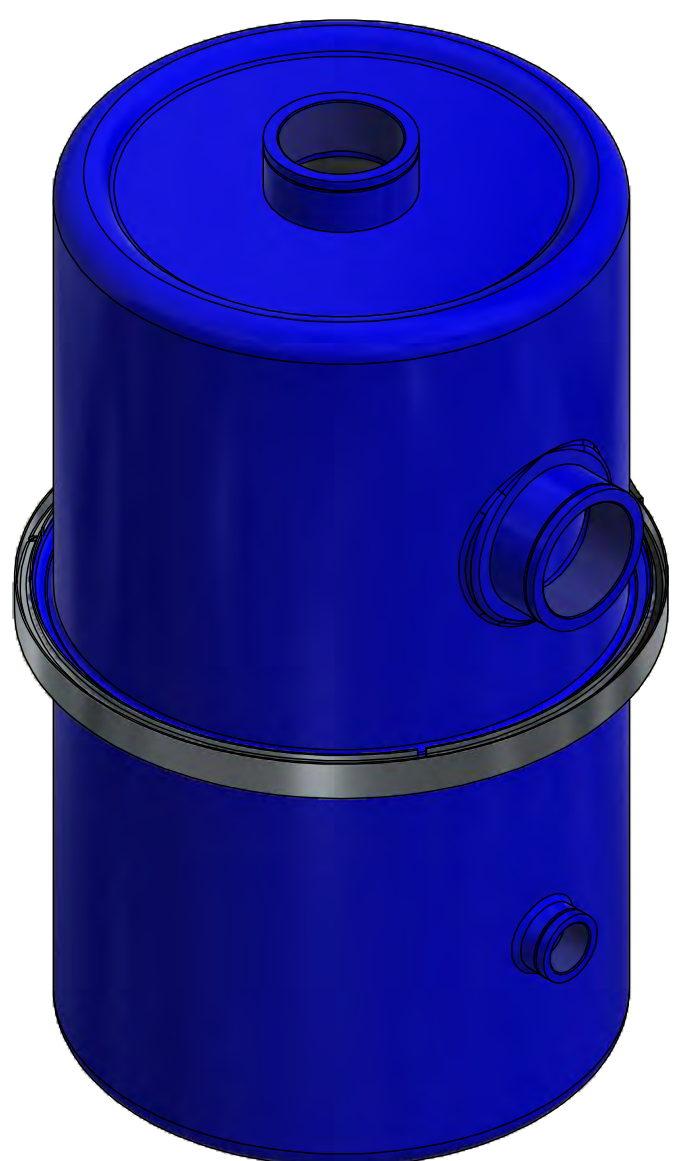

ELEMENT SPECS		
PART NUMBER	237	
MATERIAL	Polyester	
FLOW RATE	550 CFM	934 m³/hr
SURFACE AREA	8.0 ft²	0.7 m²
I.D.	4.69"	119mm
O.D.	7.75"	197mm
HEIGHT	8.63"	219mm

MODEL #: LRS-237-251HC		MATERIAL: CARBON STEEL		FINISH: BLUE POWDER	
MODEL NUMBER: LRS-237-251HC					SHEET: 1 OF 1
DESCRIPTION: LRS-237-251HC, BLUE POWDER					
PROJECT: SD11394		DRAWN BY: CRW DATE: 3/31/2004		APPROVED BY: P.G. DATE: 4/5/2004	
				REV A	

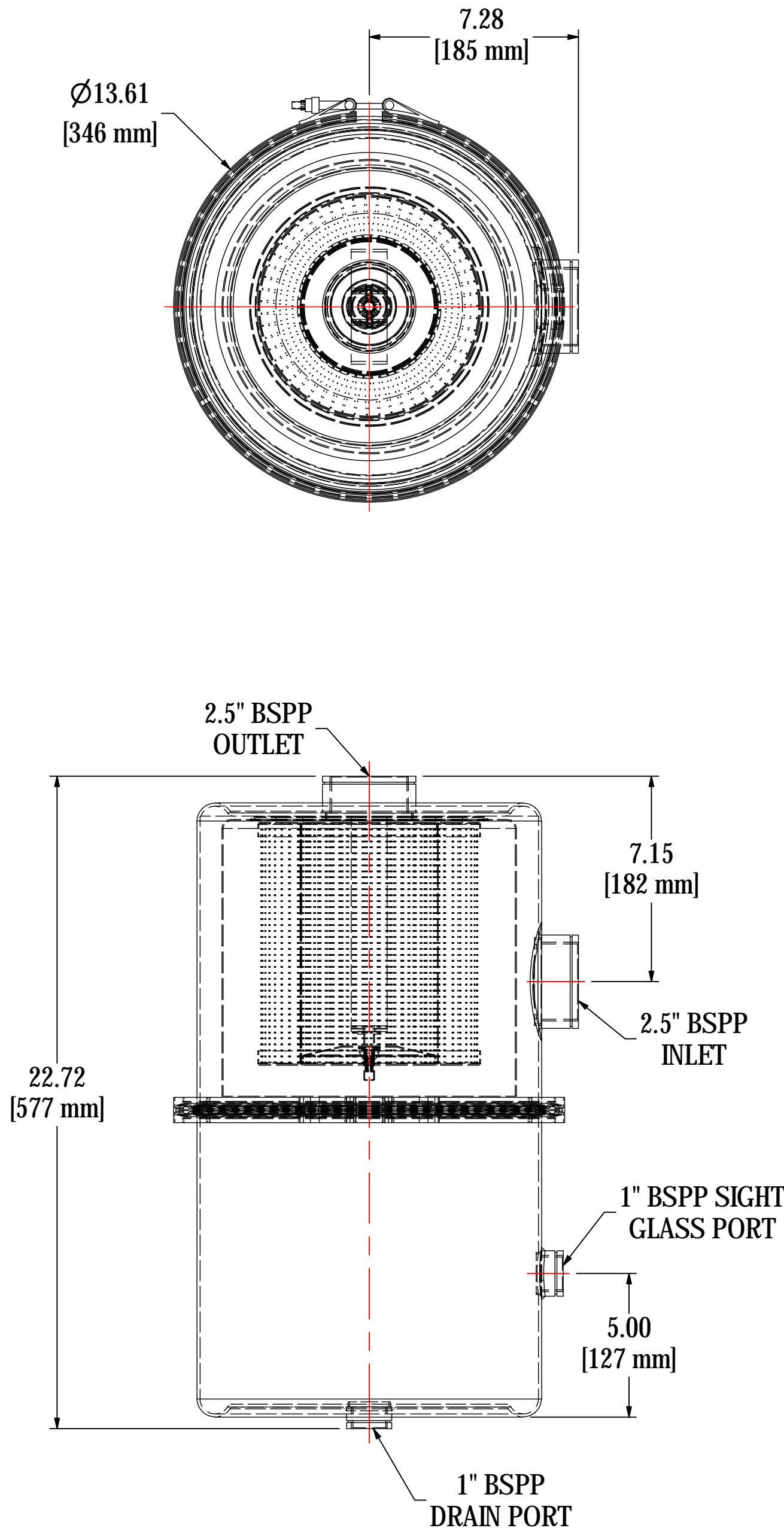

SOLBERG®
Filtration • Separation • Silencing
630.773.1363 • www.solbergmfg.com

THE INFORMATION CONTAINED HEREIN IS CONFIDENTIAL AND THE PROPERTY OF SOLBERG MANUFACTURING INC. AND IT IS FURNISHED TO YOU WITH THE EXPRESS UNDERSTANDING THAT IT WILL NOT BE REPRODUCED, COPIED IN ANY MANNER, LOANED OR OTHERWISE TRANSFERRED TO OTHERS ENTIRELY OR IN PART, NOR USED FOR ANY PURPOSE OTHER THAN FOR WHICH IT WAS FURNISHED. IT WILL BE RETURNED UPON REQUEST TO SOLBERG MANUFACTURING INC. THE ABOVE RESTRICTION IS IN ADDITION TO, AND DOES NOT IN ANY WAY ALTER, ANY OTHER RESTRICTIONS WHICH MAY APPLY TO THE INFORMATION CONTAINED HEREIN.

TOLERANCES
DIMENSIONS ARE FOR REFERENCE ONLY. ALL DIMENSIONS ARE SUBJECT TO CHANGE UPON PRODUCTION.

UNLESS OTHERWISE SPECIFIED:
-DIMENSIONS ARE IN INCHES
-REF: APPROXIMATE DIMENSIONS, NO TOLERANCES APPLY
-FINISH: BREAK EDGES TO .005-.020 RADIUS/CHAMFER