

REV	DESCRIPTION	ECN #	CHG BY	DATE	APP'D
A	UPDATED PART NUMBER, WAS CSL	15527	EZR	02/14/19	TAS
B	UPDATED TO CURRENT STYLE	18198	NAS	01/23/20	JSR

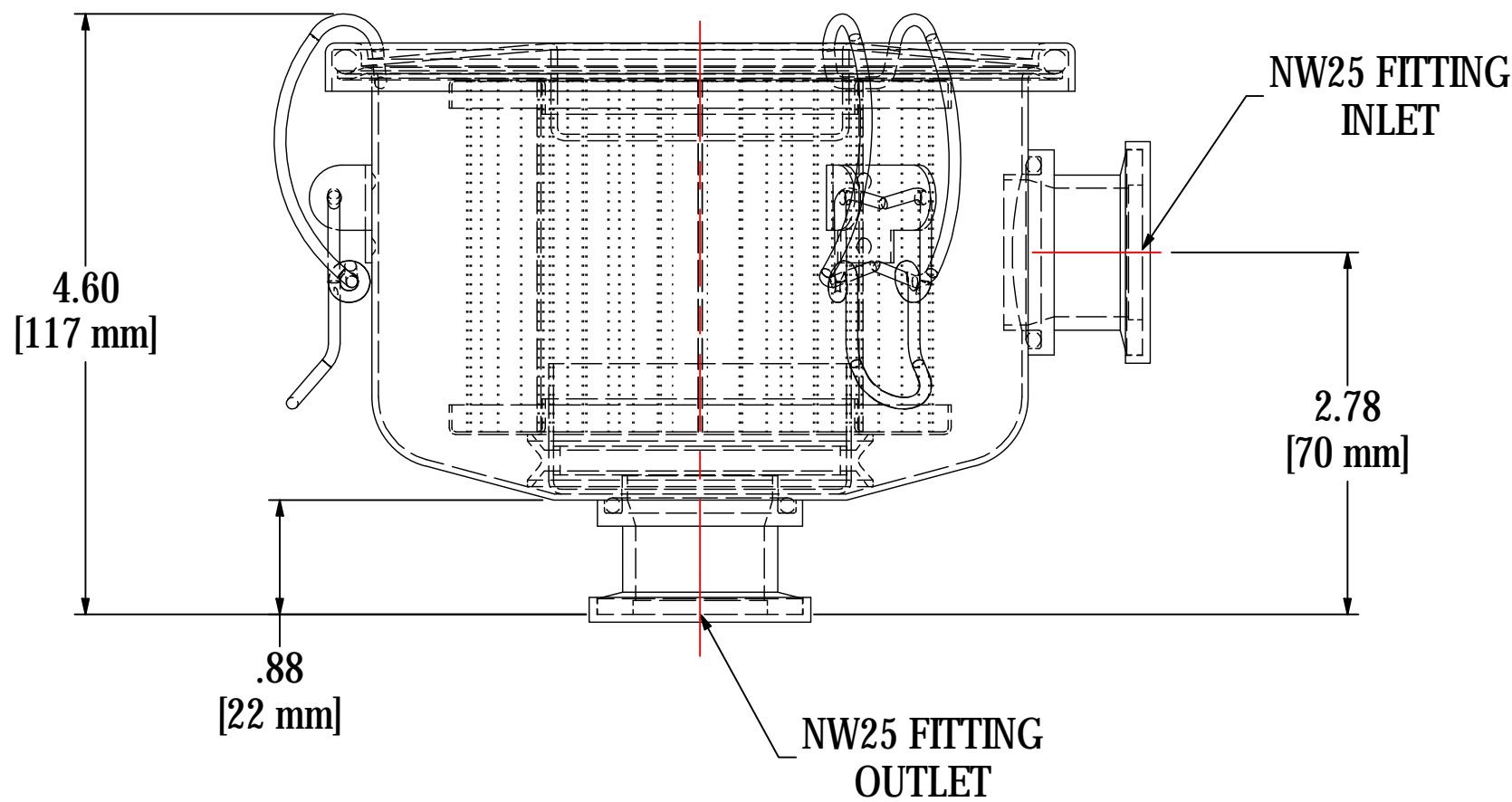
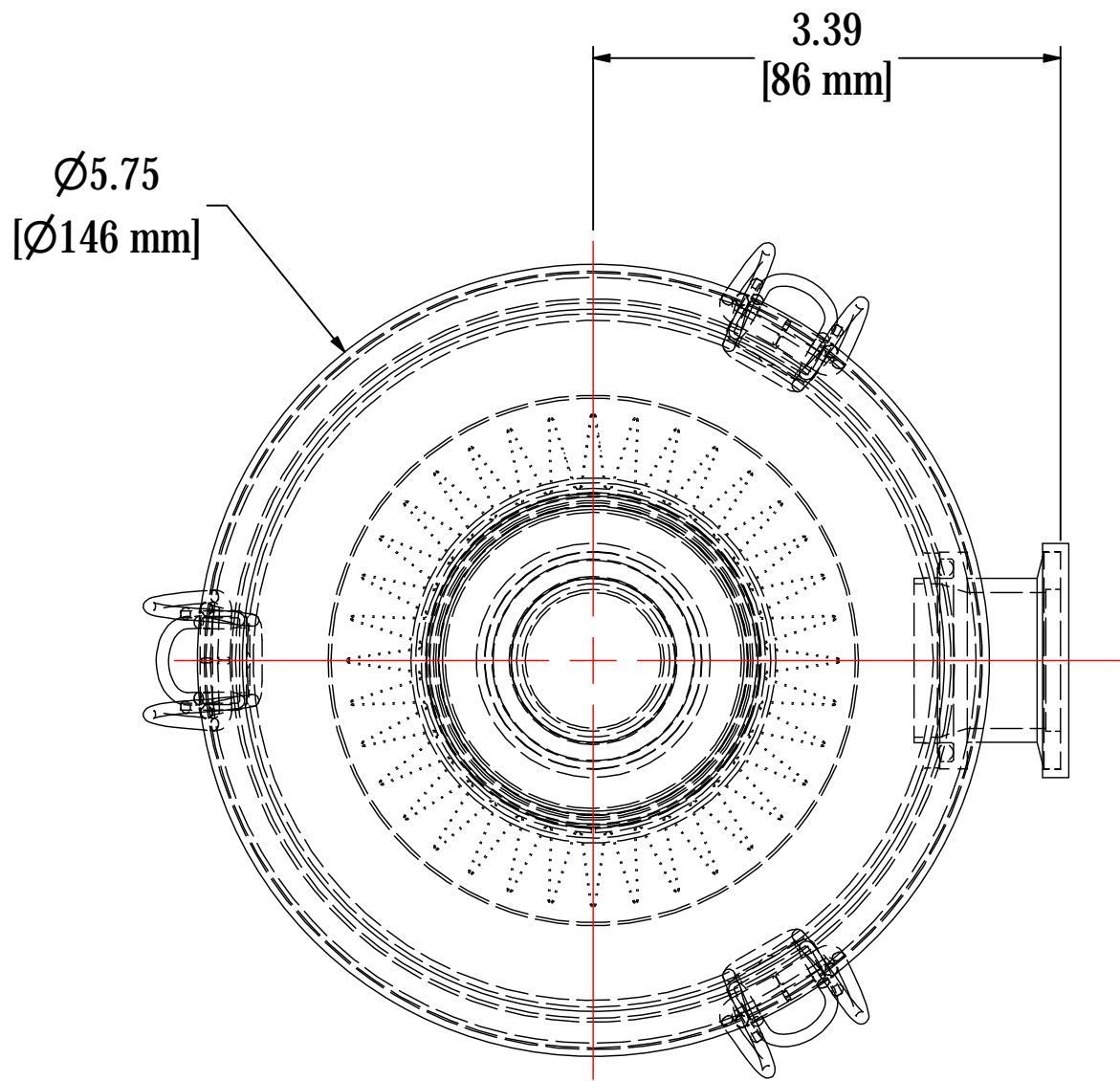

**NOTES & SPECIFICATIONS:**

1. FLANGES TO BE PROTECTED DURING PRODUCTION & SHIPMENT.
2. UNIT TO BE HELIUM LEAK TESTED TO 1 x 10<sup>-5</sup> mbar L/s.

ELEMENT SPECS		
PART NUMBER	843	
MATERIAL	POLYESTER	
FLOW RATE	55 CFM	93 m³/hr
SURFACE AREA	0.6 ft²	0.1 m²
I.D.	2.38"	60mm
O.D.	3.85"	98mm
HEIGHT	2.73"	69mm

MODEL #: WL-843-NW25B		MATERIAL: CARBON STEEL		FINISH: BLACK POWDER	
MODEL NUMBER: WL-843-NW25B					SHEET: 1 OF 1
DESCRIPTION: WL-843-NW25B, BLACK					
PROJECT: SD18629		DRAWN BY: CRW DATE: 9/27/2012		APPROVED BY: MJC DATE: 9/27/2012	
				REV B	